

PIPE VALVES

Valve Stubs, Tee Valves, Elbow Valves

Valve Stub w/ MIPT

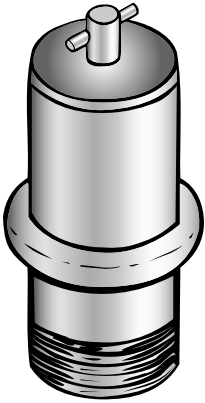

NI Part Number		Size
Aluminum	Steel	
----	966135	3" x 2"
966133	966136	3" x 3"
----	966137	4" x 3"
966134	966138	4" x 4"
----	966139	5" x 5"
----	966140	6" x 6"

- First digit indicates valve size.
- Second digit indicates thread size.

Valve, Tee, Opener, Ring Lock

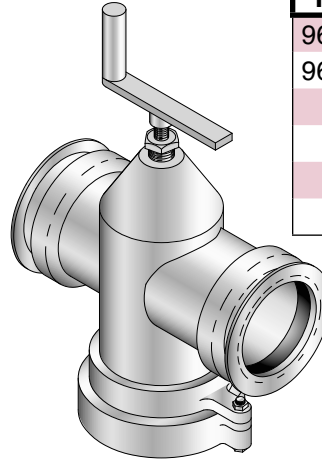

NI Part #		Size
Alumi-num	Steel	
966167	966185	4" x 3" x 3"
966168	966186	4" x 4" x 4"
----	966187	6" x 4" x 4"
----	966188	6" x 6" x 6"
----	966189	8" x 6" x 6"
----	966190	8" x 8" x 8"

Valve Stub w/ FIPT

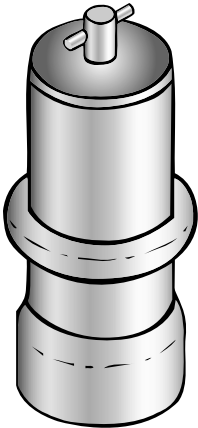

NI Part Number		Size
Aluminum	Steel	
966141	966148	3" x 2"
966142	----	3" x 2.5"
966143	966149	3" x 3"
966144	966150	4" x 3"
966145	966151	4" x 4"
966146	966152	5" x 5"
966147	966153	6" x 6"

- First digit indicates valve size.
- Second digit indicates thread size.

Valve, Elbow, Opener, Ring Lock

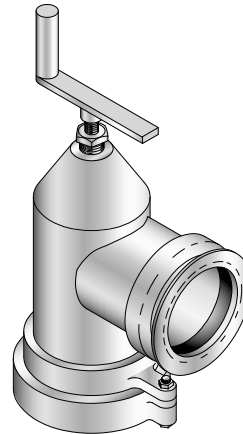

NI Part #		Size
Alumi-num	Steel	
966175	966191	3" x 2"
966176	966192	3" x 3"
966177	966193	4" x 3"
966178	966194	4" x 4"
----	96644	6" x 4"
----	96688	6" x 6"
----	966195	8" x 6"
----	966196	8" x 8"

Valve Stub

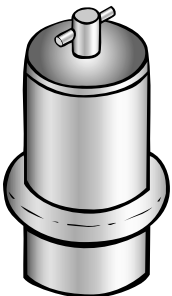

NI Part Number		Size
Aluminum	Steel	
966154	966158	3"
966155	96685	4"
966156	966159	5"
966157	96682	6"

Valve Stub, Saddle Mount

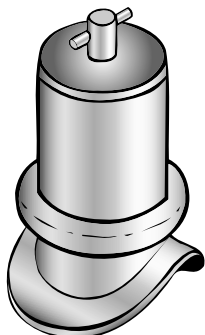

NI Part #	Size
Aluminum	
966160	4" x 4"
966161	4" x 5"
966162	4" x 6"
966163	4" x 7"
966164	4" x 8"
966165	4" x 10"
966166	4" x 12"

Valve Stub Replacement Parts

Valve Stub Stem

Please specify length and diameter of thread.

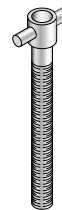

NI Part #	Size
93118	3" or 4"
93119	5" or 6"
93113	8"
93117	10"

Valve Stub Disc, Domed

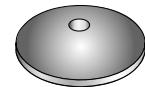

NI Part #	Size
47022	3"
47007	4"
47023	5"
47009	6"
47015	8"
47024	10"

Flat discs also available.

G