

TOWER CONTROL BOX PARTS

**NI Intermediate Control Box — 22018  
and NI Stall Control Box — 22024**

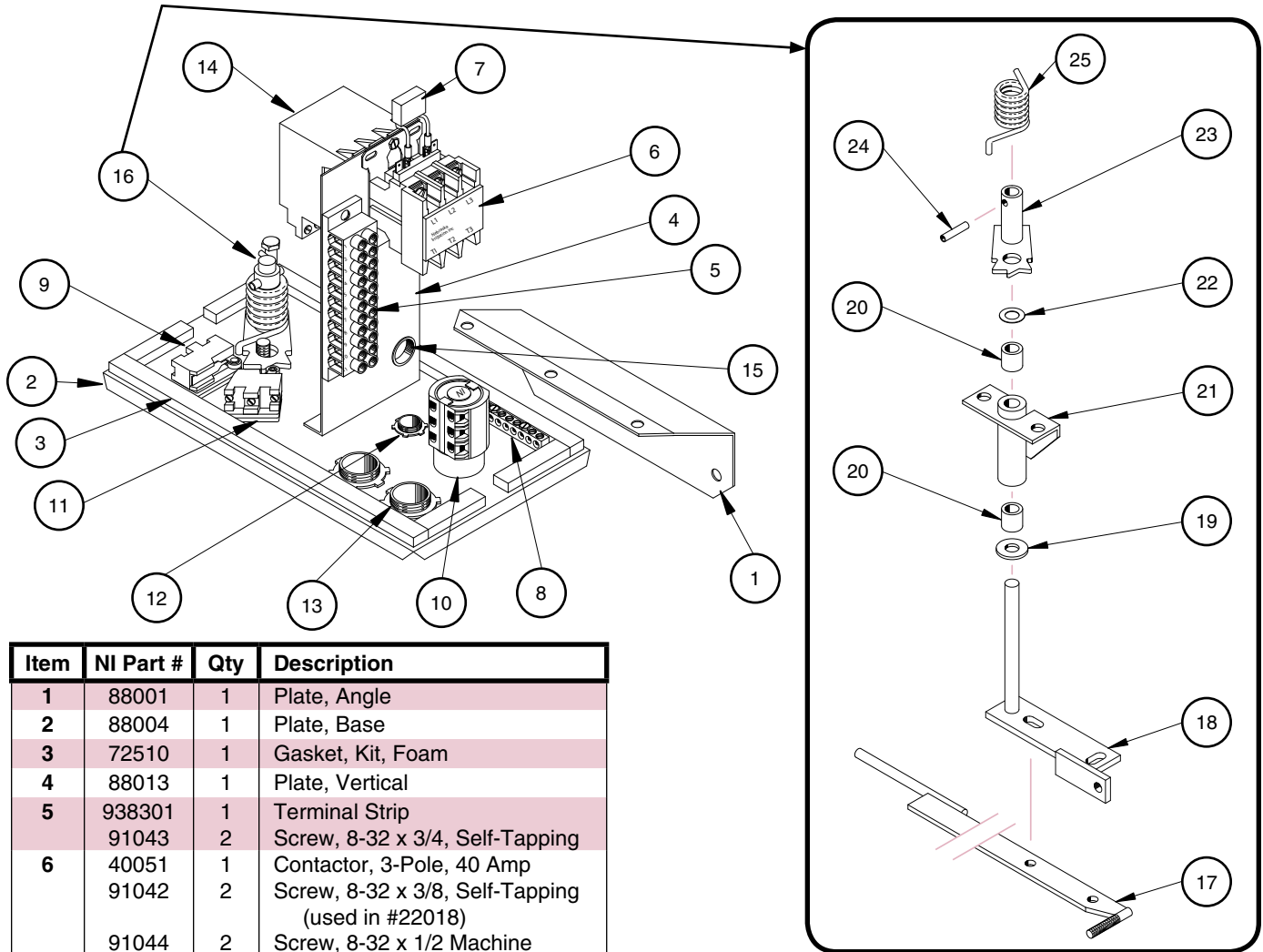

Item	NI Part #	Qty	Description
1	88001	1	Plate, Angle
2	88004	1	Plate, Base
3	72510	1	Gasket, Kit, Foam
4	88013	1	Plate, Vertical
5	938301	1	Terminal Strip
6	91043	2	Screw, 8-32 x 3/4, Self-Tapping
6	40051	1	Contactor, 3-Pole, 40 Amp
6	91042	2	Screw, 8-32 x 3/8, Self-Tapping (used in #22018)
6	91044	2	Screw, 8-32 x 1/2 Machine (used in #22024)
6	82049	2	Nut, 8-32 (used in #22024)
7	93402	1	Suppressor, Arc
8	77005	1	Lug, Ground, Strip
8	91043	2	Screw, 8-32 x 3/4, Self-Tapping
9	93652	2	Switch, Micro, Short Arm
9	91040	4	Screw, 6/32 x 1 1/4" Steel
9	82006	4	Nut, Mach Screw, 6-32 Z
10	93601	1	Switch, Disconnect
11	91823	4	Spacer, Microswitch, Plastic
12	39006	1	Connector, Cord, w/ Jam Nut, 1/2" (option w/ basic box)
13	39007	2	Connector, Cord, w/ Jam Nut 1" (option w/ basic box)
14	94403	1	Timer, Stall, OFF-Delay (used on stall control box only)
15	24008	1	Bushing, Grommet
16	----	--	(See Cam & Linkage Diagram)

**Cam and Linkage Parts  
for Intermediate and Stall Control Boxes**

Item	NI Part #	Qty	Description
17	89902	1	Rod, Weldment, Linkage
18	12062	1	Arm, Weldment
19	97273	1	Washer, Plastic
20	24067	2	Bushing Insert
21	24070	1	Bushing, Cam
22	91803	1	Spacer, Control Arm
23	26022	1	Cam
24	85002	1	Pin, Roll
25	92604	1	Spring, Torsion

**Note:** NI controls and parts can be used as direct replacements for Valley style boxes.