

SPRAYS

LDN Components and Options

Senninger LDN® Flow Chart

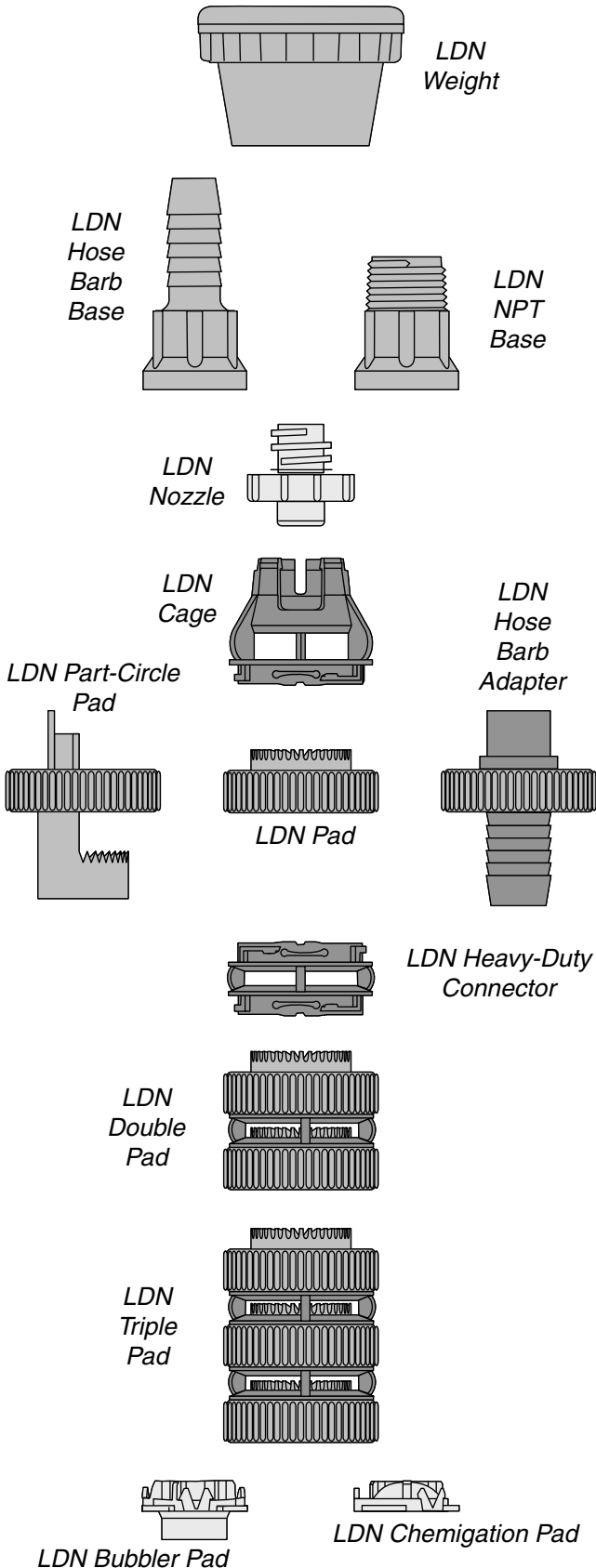

Senninger LDN Flow Data – in gallons per minute						
Nozzle #, Color, Size			Nozzle Pressure – psi			
			6*	10	15	20*
#5	Beige	5/64"	.43	.55	.66	.76
#6	Gold	3/32"	.64	.82	.98	1.14
#7	Lime	7/64"	.87	1.12	1.34	1.56
#8	Lavender	1/8"	1.12	1.45	1.73	2.01
#9	Grey	9/64"	1.41	1.82	2.17	2.52
#10	Torquoise	5/32"	1.74	2.25	2.69	3.12
#11	Yellow	11/64"	2.05	2.65	3.21	3.76
#12	Red	3/16"	2.45	3.16	3.81	4.45
#13	White	13/64"	2.92	3.77	4.50	5.23
#14	Blue	7/32"	3.40	4.39	5.24	6.09
#15	Dark Brown	15/64"	3.91	5.05	6.03	7.00
#16	Orange	1/4"	4.48	5.79	6.91	8.03
#17	Dark Green	17/64"	5.03	6.50	7.76	9.01
#18	Purple	9/32"	5.62	7.25	8.65	10.04
#19	Black	19/64"	6.19	7.99	9.54	11.08
#20	Dark Turquoise	5/16"	6.78	8.75	10.44	12.13
#21	Mustard	21/64"	7.37	9.52	11.36	13.20
#22	Maroon	11/32"	7.97	10.29	12.28	14.27
#23	Cream	23/64"	8.86	11.18	13.34	15.50
#24	Dark Blue	3/8"	9.34	12.06	14.40	16.73

* For optimum performance, Senninger recommends operating the LDN at 10 to 15 psi.

Half-size nozzles also available.

Figures reflect actual test data obtained under ideal conditions.

Consult factory for higher flow demands.

